

Drawing No.	Rev.	Page
WE-402UB-LAN-W18	A	1 / 5

SPECIFICATIONS

Product Name : Wall mount Signal Tower

Model : WE-402UB-LAN

PATLITE Corporation

Drawing No.	Rev.	Page
WE-402UB-LAN-W18	A	2 / 5

1. General Specification

Rated Voltage		24V DC
Operating Voltage Range		Rated Voltage $\pm 10\%$
Rated Current Consumption	Max.	230mA
Rated Power Consumption	Max.	5.5W
Operating Ambient Temperature		-10°C to +55°C
Operating Ambient Humidity		Less than 85% (No freezing, No condensation)
Storage Ambient Temperature		-10°C to +60°C
Storage Ambient Humidity		Less than 85% (No freezing, No condensation)
Mounting Location		Indoor/Wall mount
Mounting Direction		Upright
Protection Rating		IP23 (IEC 60529) *Excludes mounting screws
Environmental Condition		Wall mount/Upright
Insulation Resistance		More than 1M Ω at 500VDC between live part and non-current carrying metallic part
Withstand Voltage		500VAC applied for 1min between live part and non-current carrying metallic part without breaking insulation
Luminous part	Number of Signal Tower Tiers	4 tiers
	Luminous Color	9 colors
	Flashing Pattern	10 patterns
Buzzer part	Buzzer Pattern	7 patterns
	Sound Pressure Level	Typ. 88dB (Sound Reduction : Approximately -10dB)
	Environmental Conditions	Max. Volume, Buzzer Aperture Direction at/1m
Mass (Tolerance $\pm 10\%$)		420g
Outer Dimensions		Refer to the Outer Dimension Drawing
Interfaces	Power Supply Input	UL1061 AWG24 $\times 2$ (24V DC,GND)
	Ethernet	RJ-45 Connector (Female)
Network Communication Format		Ethernet (IEEE802.3 Conformity) 10BASE-T/100BASE-TX (Auto-MDI/MDIX)
Status Lamp		LED $\times 1$ (Bottom side)
Operation Interface		Switch for Initialize $\times 1$ pc (Bottom side/Controll after removing the Cover)
Accessory		Screw(M4X25) $\times 4$ pcs
		Plain Washer($\phi 4$ X8X0.5) $\times 4$ pcs
		M4 Nut $\times 4$ pcs
Optional Parts		Nothing
Conformity Standards		UL508, CSA-C22.2 No.14 FCC Part15 SubpartB ClassA, ICES-003 Issue 7(Class A) EN 61000-6-4, EN 61000-6-2, KS C 9610-6-4, KS C 9610-6-2
Remarks		<ul style="list-style-type: none"> • Due to the characteristics of the LED elements, there may be a slight variation in color tone and brightness between products • Conforms to the CE requirements • Conforms to the UKCA requirements • UL Recognized Component(File No.E215660)

2. Model Number Configuration

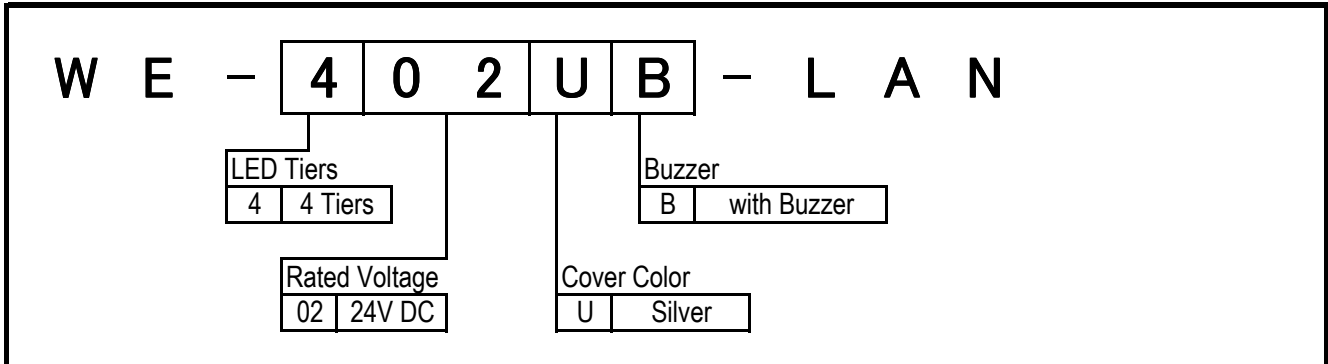

3. Operation Specification

Signal Tower Control	Each tiers and buzzers of Signal Tower can be controlled with pre-registered colors and volumes	
Signal Tower Control	10 Patterns , Light off(Controllable at each tiers)	
Display Color Variations	9 Colors	
Buzzer Sound	7 Patterns	
Detailed Command Control	Can be controlled by specifying the signal Tower display color and buzzer pattern	
Signal Tower Control	10 Patterns , Light off(Controllable at each tiers)	
Display Color Variations	9 Colors	
Buzzer Sound	7 Patterns	
Detail of Signal Tower control	Pattern 1	ON Always
	Pattern 2	Flashing(0.5sec ON / 0.5sec OFF)
	Pattern 3	Flashing(0.25sec ON / 0.25sec OFF)
	Pattern 4	Flashing(0.1sec ON / 0.1sec OFF)
	Pattern 5	Single Flash
	Pattern 6	Double Flash
	Pattern 7	Triple Flash
	Pattern 8	Pulse Pattern
	Pattern 9	Right Chase Light
	Pattern 10	Left Chase Light
Detail of Display Color	Color 1	Red
	Color 2	Amber
	Color 3	Lemon
	Color 4	Green
	Color 5	Cyan
	Color 6	Blue
	Color 7	Purple
	Color 8	Pink
	Color 9	White
Detail of Buzzer Sound	Pattern 1	On Always, 2420Hz
	Pattern 2	2420Hz, 0.05sec ON / 0.05sec OFF
	Pattern 3	2420Hz, 0.5sec ON / 0.5sec OFF
	Pattern 4	On Always, 3600Hz
	Pattern 5	3600Hz, 0.05sec ON / 0.05sec OFF
	Pattern 6	3600Hz, 0.5sec ON / 0.5sec OFF
	Pattern 7	Rapid Hi-Lo 2420Hz & 3600Hz

Drawing No.	Rev.	Page
WE-402UB-LAN-W18	A	4 / 5

4. Function Specification

4.1 Signal Tower & Buzzer Control Function

Modbus/TCP	Controllable with Modbus/TCP
HTTP Command	Controllable with HTTP Command
Socket Communication	Controllable with PNS Command

4.2 Status Acquisition Function

Modbus/TCP	Current status of Signal Tower, Buzzer can be acquired
HTTP Command	Current status of Signal Tower, Buzzer and Firmware Version by HTTP Command can be acquired
Socket Communication	Current status of Signal Tower, Buzzer by PNS Command can be acquired

4.3 Setting Function

Automatic Network Setting	Network setting in this product can communicate with a DHCP server to be set automatically
Signal Tower Color Setting	Signal Tower Color can be changed by setting the WEB browser.
Volume Control	Buzzer Volume can be set with the WEB browser.
Configuration Setting	Various configuration of the product can be read and written as setting files
Main Unit Setting	Various setting to the Main Unit can be accessed by the WEB browser Supported OS : Microsoft Edge, Google Chrome
Firmware Update	Firmware of the main unit can be updated using WEB browser.
Supported Language (Web)	English / Japanese

1

2

3

4

5

6

7

8

A

B

C

D

E

F

指定 公差 General Tolerance	角度公差 ±[°]			寸法公差 ±[mm]					図番 Drawing No.		ページ Page			
	短辺 長さ Length of short side	~	~100	6	30	120	300	1000	WE-402UB-LAN-W18		5 / 5			
	精 f	1	0.5	0.3	0.1	中 m	0.1	0.3	0.5	0.7	1	改訂 Rev.	年月日 Date	改訂履歴 Revisions
	粗 v	3	1.5	1	0.5	粗 c	0.3	0.5	1	1.2	2			

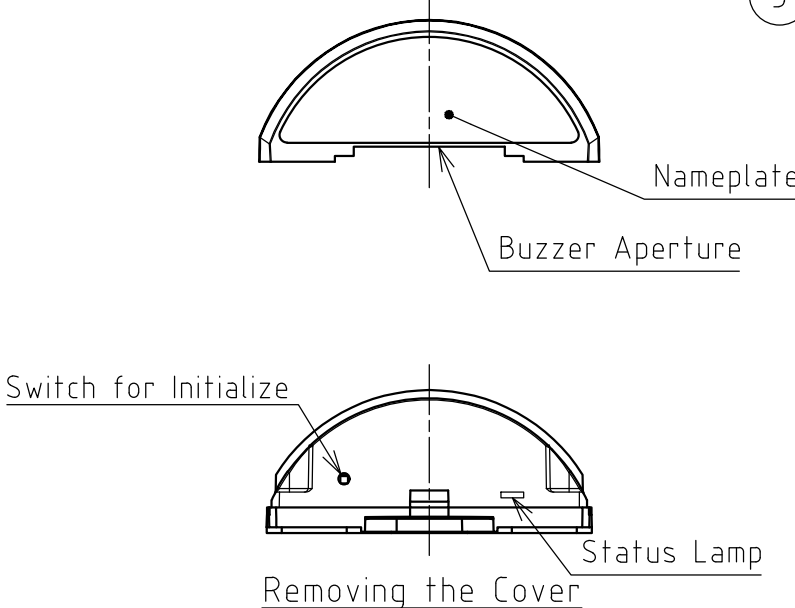
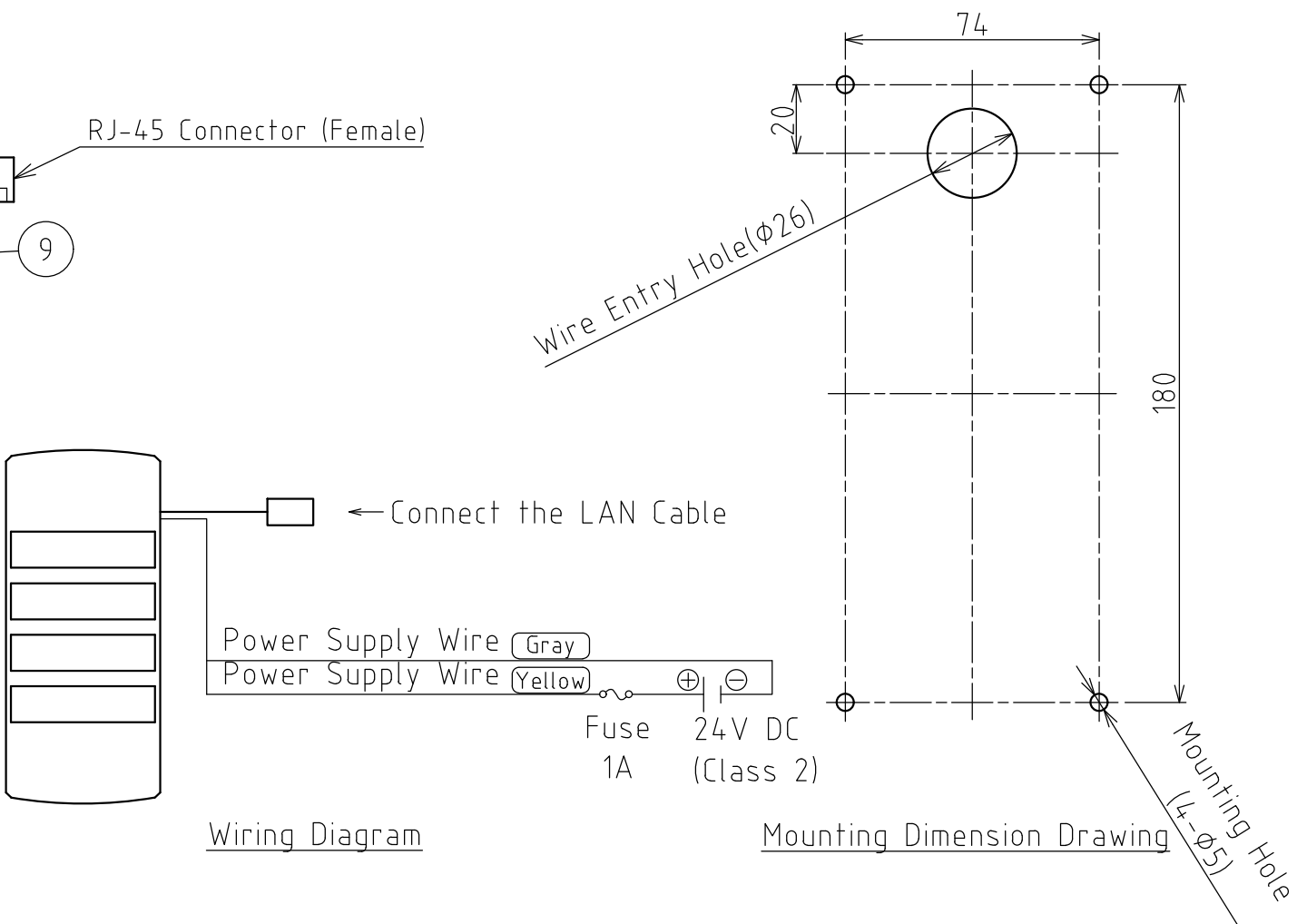
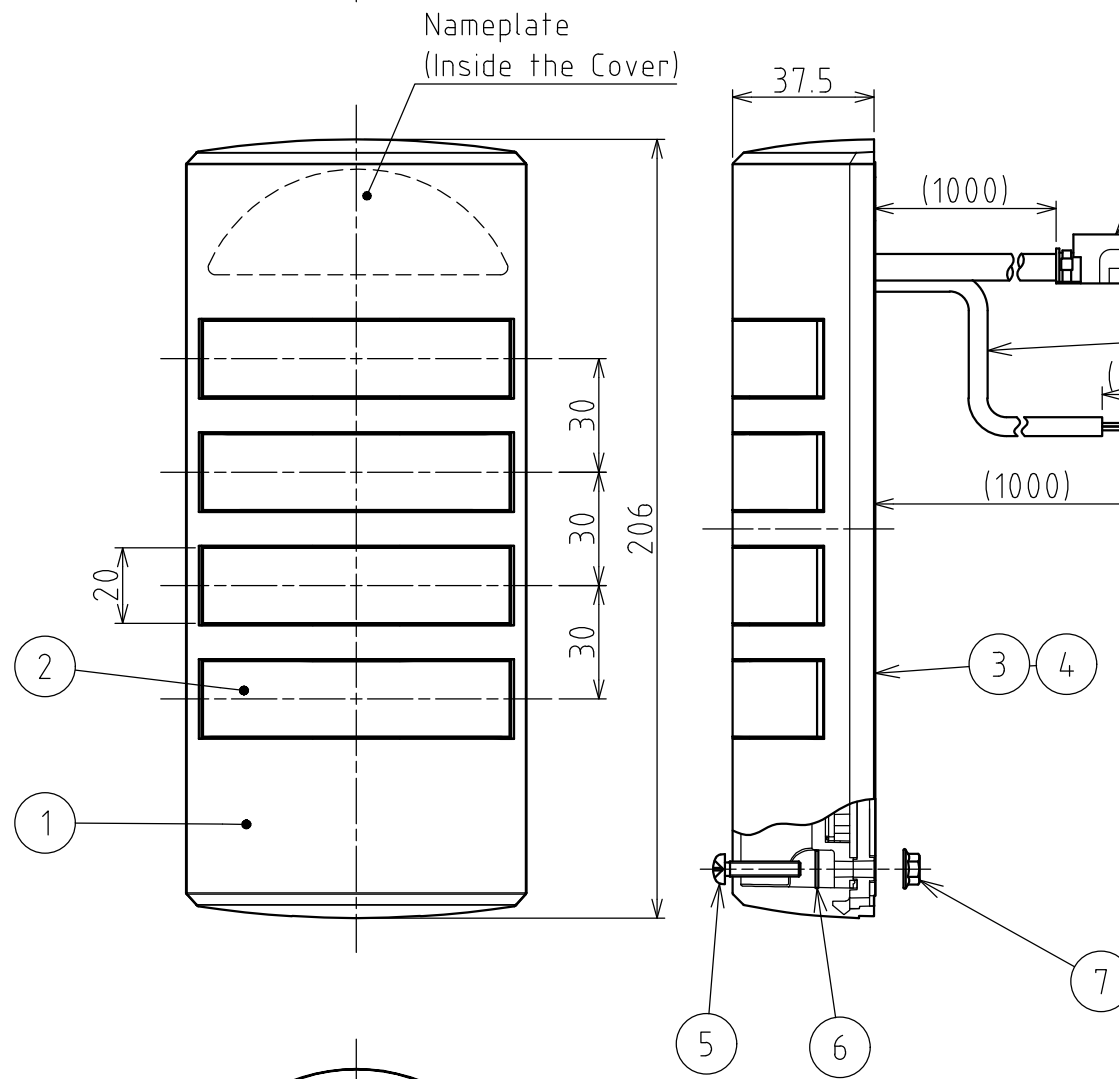
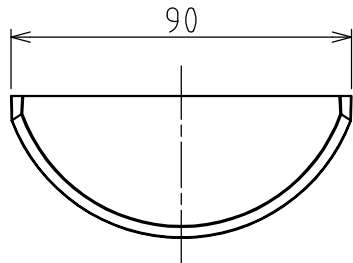

9	Power Supply Wire	1	UL1061 AWG24
8	LAN Cable	1	
7	Hexagon Nut	4	M4 / Accessories, Steel
6	Plain Washer	4	φ4x8x0.5 / Accessories, Steel
5	Screw	4	M4 / Accessories, Steel
4	Waterproof Sheet	1	CR
3	Case	1	ABS / Off-White
2	Lens	1	PC / Clear
1	Cover	1	ABS / Chromium Plating
番号 No.	部品名 Part Name	数量 Qty.	記事 Remarks

機種 Model	WE-402UB-LAN	特注No. S.P.No.	-	図名 Name	Outer Dimensions Drawing
品目コード Part No.	-	尺度 Scale	1:2	三角法 3rd Angle P.	単位 Unit mm
		株式会社 PATLITE Corporation		Ver.2.2 A3	